

BANG & OLUFSEN

BEOSOUND 9000



*This Setting-up guide explains how to set up your BeoSound 9000 and make it ready for use.*

*The BeoSound 9000 may also be used in a fully integrated Bang & Olufsen AV system (see the sections "Connections" and "Ready for use..."). Please contact your Bang & Olufsen dealer.*

*We recommend that you follow the instructions in this guide carefully and suggest that you proceed as recommended here:*

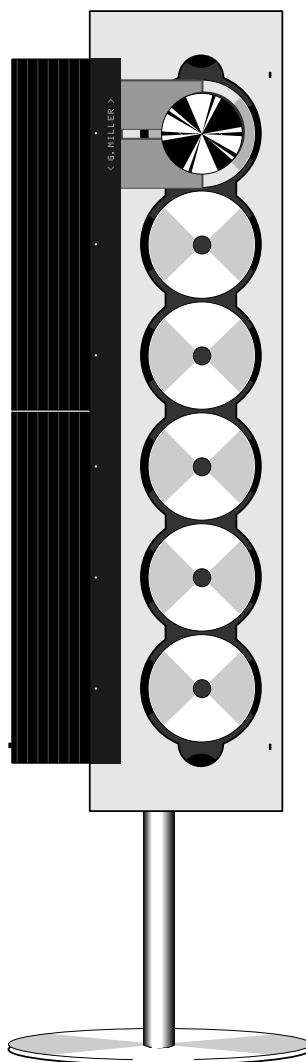
- *Study the section "Placement" in this guide carefully in order to decide how and where to place the BeoSound 9000.*
- *If your setup includes one of the optional brackets or the stand, then assemble this according to the separate folder enclosed with the accessory.*

■ *Set up your loudspeakers (or, if the BeoSound 9000 is to be used in a Bang & Olufsen AV system, set up this system) following the procedures described in the guides enclosed with these products.*

■ *Make your connections to the BeoSound 9000 and proceed with your setup as described in this guide.*

*NOTE: Do not connect the BeoSound 9000 (or any other product) to the mains before you have completed the setting-up procedure!*

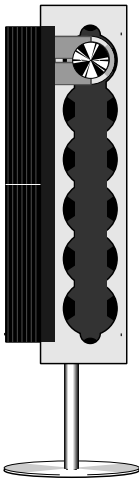
*Please refer to the BeoSound 9000 User's guide (also enclosed) for detailed operating instructions.*



---

## Contents

- 4 Placement
- 7 Connections
- 9 Ready for use...
- 12 Maintenance
- 13 Miscellaneous information



**Fig. 1:** *The BeoSound 9000 placed in a vertical position using the Stand type 2055. When placed like this, the CD mechanism must be centered for a vertical position. The Stand is supplied with two different sets of feet:*

- spikes for use on a carpeted floor
- rubber feet for use on a non-carpeted floor

*Do not lift or move the Stand around while the BeoSound 9000 is mounted.*

As illustrated in this section (figs 1 – 7) the BeoSound 9000 is designed for a variety of placements. Its compactness facilitates placement next to your favourite listening position, which is also optimal for close-up operation of the system. It can be placed on a special stand, on a shelf or a table in various positions – or hanging off the wall (using one of the optional wall brackets).

■ At the end of this section is described how to centre the CD mechanism for the different setup situations mentioned here – *this is very important for the functioning of the CD player!*

■ In the section “Ready for use...” is described how to turn the close-up operation panel (and the display) so it can be read from your preferred angle.

■ The BeoSound 9000 is designed for use in dry environments only, and for use within a temperature range of 10 – 40° C (50 – 105° F).

■ Avoid placing the BeoSound 9000 in direct sunlight or direct artificial light (e.g. a spotlight), or near objects generating electrical noise (e.g. dimmers), as this will reduce the sensitivity of the remote control receiver.

■ Place the BeoSound 9000 so that ventilation will not be impeded, and remember to leave enough space above or in front of the BeoSound 9000 for the glass door to open, and to facilitate close-up operation.

■ If you are going to hang the BeoSound 9000 on the wall, always use the correct size and type of screws and wall plugs to support the weight of the BeoSound 9000 (depending on the material and the construction of the wall).

If in doubt, consult your Bang & Olufsen dealer.

■ Light partition wall are often constructed of gypsum panels – known as drywall or wall board – secured to vertical studs. Gypsum is not a satisfactory material to support the weight of the BeoSound 9000! If you wish to hang your BeoSound 9000 on a gypsum wall, using one of the brackets, we recommend that at least one mounting screw be a lag screw, which is screwed securely into a vertical wall stud.

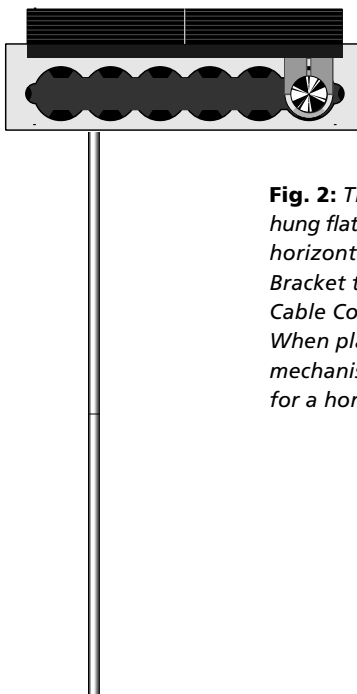
■ When hanging the BeoSound 9000 on the wall (as shown in figs 2, 3, and 7) we recommend that you conceal the cables using the optional Cable Cover type 2062.

This cable cover has an overall length of 75 cm (29½"). The folder enclosed with the cable cover describes how and where to fasten it in relation to the different wall brackets.

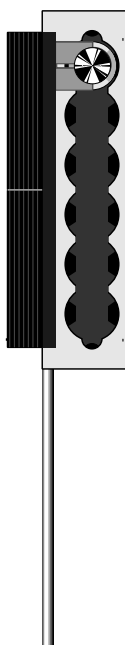
As you can see, we have used two cable covers in fig. 2, and one in figs 3 and 7, respectively. When mounted correctly this ensures that the BeoSound 9000 is hung at the optimal height for easy access to the CD compartments. The two different heights also takes the

movement of the glass door into consideration.

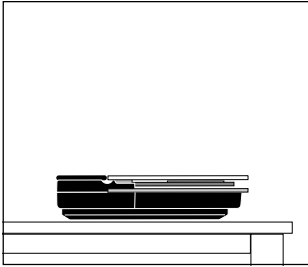
■ When lifting the BeoSound 9000 out of the box we recommend that you, in order to avoid fingermarks on the surfaces, use the two foam packing shells placed at each end of the BeoSound 9000.



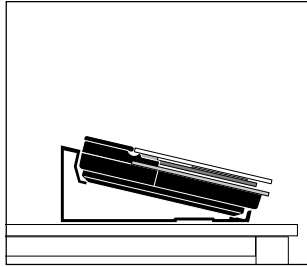
**Fig. 2:** *The BeoSound 9000 hung flat on the wall in a high horizontal position using the Bracket type 2054, and two Cable Covers type 2062. When placed like this the CD mechanism must be centered for a horizontal position.*



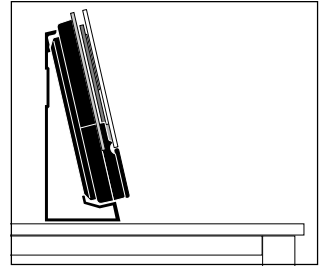
**Fig. 3:** *The BeoSound 9000 hung flat on the wall in a vertical position using the Bracket type 2063, and one Cable Cover type 2062. When placed like this the CD mechanism must be centered for a vertical position.*



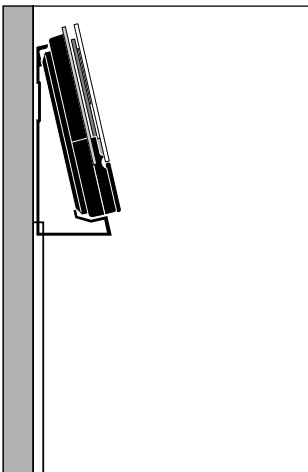
**Fig. 4:** The BeoSound 9000 placed flat on a level surface, e.g. a table or shelf. When placed like this the CD mechanism must be centered for a flat position (factory set-up).



**Fig. 5:** The BeoSound 9000 placed in a slant position on a level surface, e.g. a table or shelf, using the Bracket type 2053. When placed like this the CD mechanism must be centered as for a flat position (factory setup).

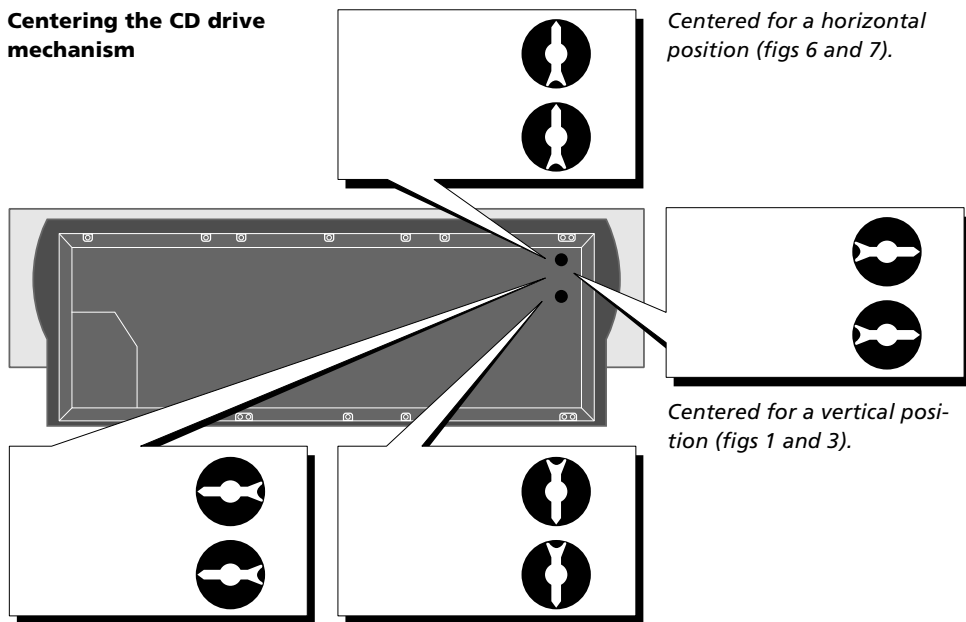


**Fig. 6:** The BeoSound 9000 placed in a near upright position on a level surface, e.g. a table or shelf, using the Bracket type 2053. When placed like this the CD mechanism must be centered for a horizontal position.



**Fig. 7:** The BeoSound 9000 hung low on the wall in a near upright position using the Bracket type 2053 and one Cable Cover type 2062. When placed like this the CD mechanism must be centered for a horizontal position.

## Centering the CD drive mechanism



Centered for a flat or near flat position (figs 4 and 5). This is the factory setup.

Centered for a horizontal position (fig. 2).

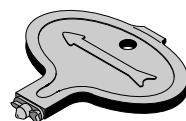
The CD mechanism is spring suspended in order to make the BeoSound 9000 'party-safe'. By centering the CD mechanism, you adjust the tension of the spring suspension to allow for different placements.

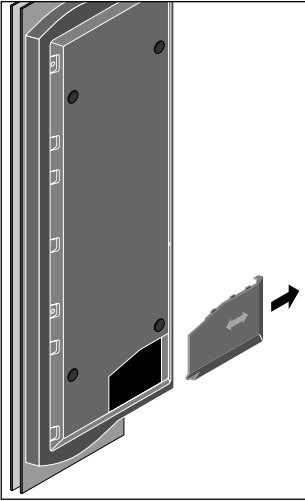
Enclosed with the Stand and the Brackets, you will find a small plastic tool, which you must use for this purpose:

- Locate the two adjustment holes in the bottom plate of the BeoSound 9000.
- Pry off the two small plastic plugs (using the chisel-shaped end of the tool).

- Insert the other end of the tool (the arrow-shaped end) and turn the tool so that the arrow in each hole points into the correct direction.
- When finished put back the two plastic plugs again.

In all but the flat and the near flat positions, both arrows in the holes must point upwards when finished. In the flat position (factory setup) they must point towards the centre of the BeoSound 9000.

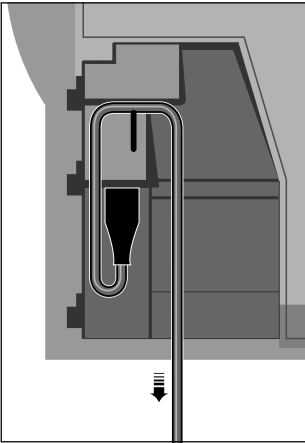




Remove the cover in the bottom plate of the BeoSound 9000 to gain access to the following sockets:

- Two sockets for the aerial connections (FM and AM).
- Two sockets for active loudspeakers (PL, i.e. Power Link).
- One socket for auxiliary equipment (AUX).
- One digital output from the CD player (DIG. OUT).
- One socket for the BeoLink connections (ML, i.e. Master Link).

Furthermore, the socket compartment contains the socket for the mains cord.



For safety reasons fasten the mains lead as shown, before running it out from the socket compartment.

### Aerial connections

In order to obtain optimal reception of radio stations it is essential to use the correct type of aerial (FM and/or AM) or cable net connection. Please let your Bang & Olufsen dealer advise you.

Connect your FM signal to the socket marked FM and your AM signal, if any, to the socket marked AM.

When using indoor aerials (either an FM dipole or AM loop aerial), tune in to the radio station you want and then turn the aerial horizontally until optimum signal is received.

### Loudspeakers

Connect your active Bang & Olufsen loudspeakers to the sockets marked PL.

You may choose to loop the signals through from speaker to speaker, as mentioned in the User's guide for your loudspeakers, or you may connect one speaker to each of the two sockets. Remember to set the L • R • LINE switch on your active speakers to L and R (left and right channel), respectively.

### Auxiliary equipment

Connect your auxiliary equipment to the socket marked AUX.

This socket enables you to connect e.g. a tape recorder or a record player (with built-in preamplifier).

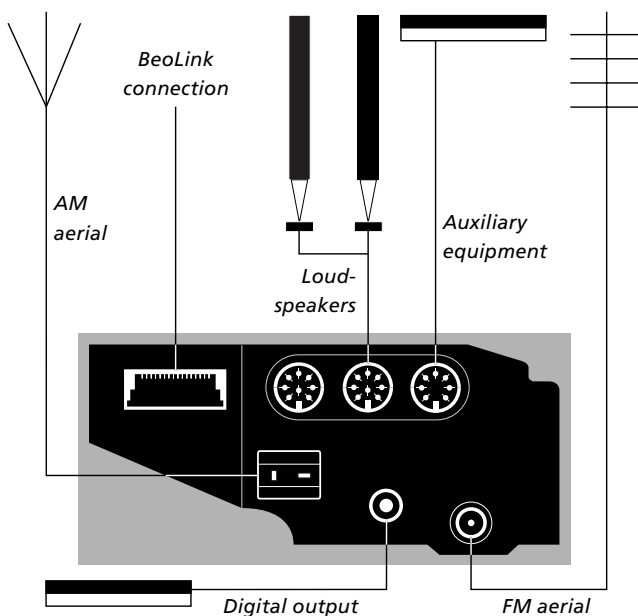
However, as this socket does not carry Data Link signals, you will not be able to operate the connected equipment by remote control. Just select A.AUX (either directly on the close-up operation panel or with the Beo4 remote control) and then operate the auxiliary equipment close-up.

### BeoLink connection

The BeoLink system enables you to set up extra speaker systems throughout your house, and listen to the BeoSound 9000 in any room you like.

Using a Master Link cable, connect one end to the socket on the BeoSound 9000 and the other end to the corresponding socket on the linked equipment.





When you have made all the connections, replace the cover to hide the socket compartment.

The cover has two perforated sections, which you can pry off in order to make a hole to run the cables through. Select one in an appropriate position to suit your setup.

If you have set up the BeoSound 9000 on the Stand, type 2055 (see page 4), a different cover must be used. This new cover is supplied with the Stand.

Finally, connect the BeoSound 9000 (and the other units in your system) to the mains.

The cable may be split (using a BeoLink junction box) in order to accommodate more link rooms. The document enclosed with the cable explains some of the possibilities.

The socket may also be used to set up a Bang & Olufsen AV system.

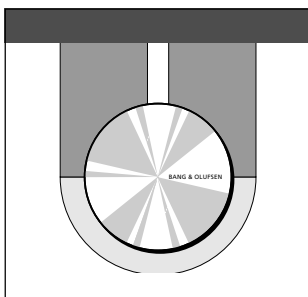
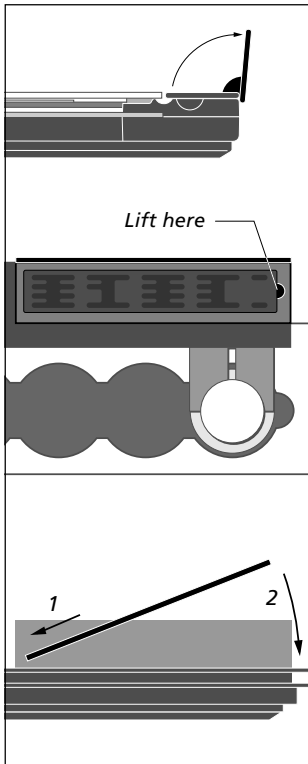
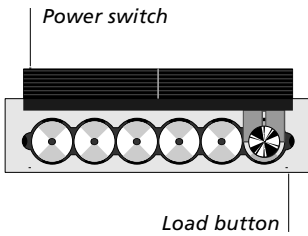
The AV system may be set up in *one room*, or split up on *two rooms* (see "Ready for use..."). BeoLink distribution of the sound from the BeoSound 9000 (and the video system) to other rooms in the house is possible in all setups. For further information, please contact your Bang & Olufsen dealer.

### Digital output

The socket marked DIG. OUT carries the digital signals from the CD player, and is intended for connecting digital equipment (output only).

### Mains supply

Plug the mains lead into the socket marked ~ .



When you switch on via the red power switch button a tiny red light appears in the display, indicating that the system is in stand-by mode, ready to be used.

Open the glass door (press the load-button). Remove the carton strip behind the CD clamper and the foam packing (these items are for transport protection of the CD drive and the glass door).

### Close-up operation panel

In order to make reading easier in all placement situations, you can turn the close-up operation panel (and thus the display):

- Switch off the power and open the lid to gain access to the close-up operation panel.
- Lift off the operation panel by inserting a finger where indicated, turn the panel, and then insert it (connectors first) again.

### Bang & Olufsen logotype

You can also rotate the CD clamper lid (with the Bang & Olufsen logotype) in order to ensure that the logotype always appear in a horizontal position.

### AV setup

If your BeoSound 9000 has been set up in an AV system, you may need to program it to the correct *Option* (refer to the diagrams on the opposite page):

*Option 0.* Used in a one-room fully integrated AV system with no speakers connected to the BeoSound 9000.

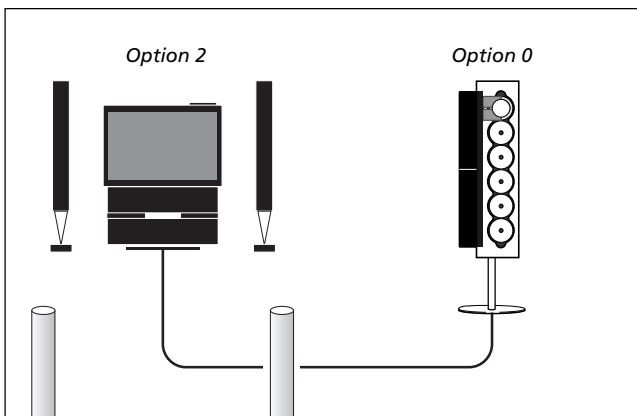
*Option 0* is selected automatically when no speakers (or headphones) are connected to the BeoSound 9000.

*Option 1 (factory setting).* Used in a one-room setup, when the BeoSound 9000 is used either on its own, or in an AV integrated setup (with a pair of active speakers connected to the BeoSound 9000).

*Option 2.* Used in a two-room AV integrated setup.

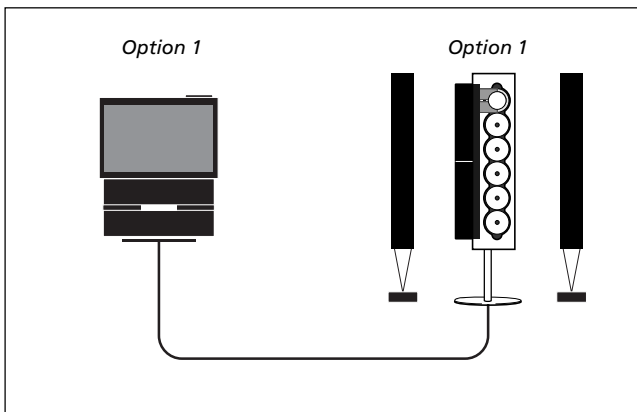
*Switch your entire Bang & Olufsen system to stand-by, and then (using the Beo4 remote control):*

- Hold the • button while pressing LIST. When the Beo4 display reads OPTION?, press GO.
- Press LIST to display A.OPT and then key in the appropriate number (1 or 2).

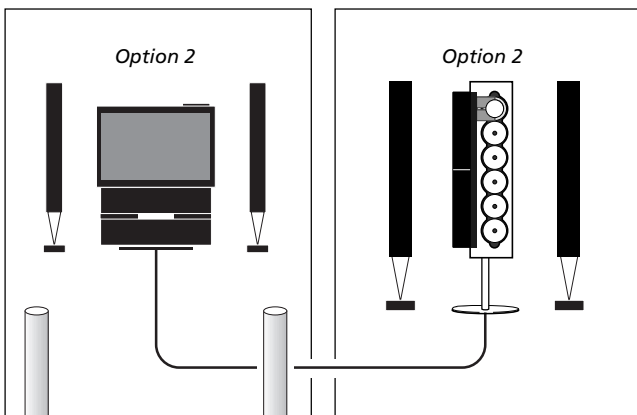


*In a fully integrated AV system, your BeoSound 9000 acts as a mere audio source. The sound is reproduced through the speakers in the BeoVision TV – or, as shown here, through a set of active speakers connected to the TV.*

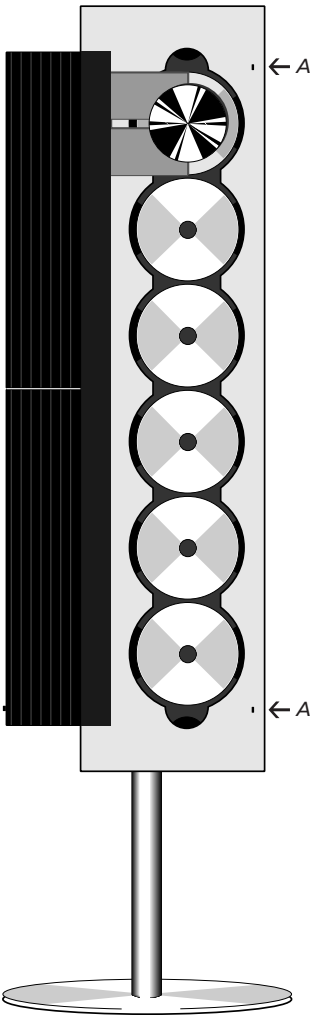
*The BeoSound 9000 is automatically set to Option 0.*



*In a one-room AV integrated setup, a pair of active speakers has been connected to the BeoSound 9000.*



*In a two-room AV integrated setup, your BeoSound 9000 has been set up with a set of active speakers in one room, and the video system in another.*



### Surfaces

Before you start cleaning the BeoSound 9000, we recommend that you open the glass door and then switch off the mains (just push the red power switch button). In this way all surfaces are accessible for cleaning. Use a soft, dry cloth to wipe dust off the BeoSound 9000. To clean the surfaces, we recommend that you use a mild window cleaner. When you have finished cleaning the BeoSound 9000, remember to switch the red power switch on again.

*NOTE! Treat the glass door with great care! If it cracks or chips, or if it is damaged in any other way, it must be replaced immediately as it could otherwise cause great bodily harm. If the glass door should need to be replaced, please contact your Bang & Olufsen dealer.*

### CD mechanism

The circuit controlling the movement of the CD carriage has a built-in safety function which protects your fingers, etc. from being hit by the fast moving carriage. This circuit depends on light/reflections, and works via opto-coupling devices built into the two small 'pegs' (A). When the glass door is opened, or if something interrupts the light-circuit, the carriage slows down in speed, and finally comes to a halt. Over time dust may build up and thus reduce the light emitted to and from the opto-coupling devices. Dust particles on the inside of the glass door may also cause extraordinary reflections which may be interpreted by the safety function in a wrong way. So, in order to prevent malfunction of the safety circuit, we recommend that you wipe dust off the two pegs (A) on a regular basis. Likewise, when cleaning the surfaces of the BeoSound 9000, remember also to clean the inner surface of the glass door.

*Do not use alcohol or other solvents to clean any part of the BeoSound 9000!*

## Handling your CDs

### IMPORTANT!

*If you experience any problems when trying to play a particular CD always check it for faults (scratches, fingerprints, dust or dirt, etc.). Dust may build up on the CDs, especially if you leave them sitting in the BeoSound 9000 for a long time.*

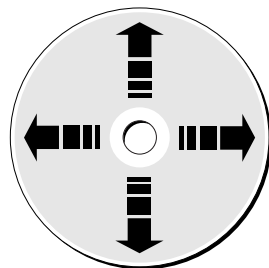
*If there are no visible faults on the CD, please contact your Bang & Olufsen dealer. Do **not** attempt to clean the optics of the CD mechanism yourself – this must be done by a qualified technician only!*

*We do not recommend using special cleaning CDs in the BeoSound 9000.*

CDs should be handled and stored with the same care as conventional records. If the CD is always held by its edges and placed in its original cassette when out of the BeoSound 9000, no cleaning will be required.

Should the CD become soiled by fingerprints, dust or dirt, it can be wiped with a clean and lint-free, soft, dry cloth.

Avoid extreme heat and humidity, and never write on your CDs.



*No solvents or abrasive cleaners should ever be used on the CD and always wipe the CD in a straight line from centre to edge.*

**CLASS 1  
LASER PRODUCT**

**COMPACT  
disc  
DIGITAL AUDIO**



The black and yellow label on the compact disc player serves as a warning that the apparatus contains a laser system and is classified as a class 1 laser product. In case of any irregularities of the compact disc player, please contact your Bang & Olufsen dealer. The apparatus must be opened by a qualified serviceman only.

**CAUTION:** The use of any controls, adjustments or procedures other than those specified herein may result in hazardous radiation exposure.

This product fulfils the conditions stated in the EEC directive 82/336 concerning radio frequency interference.

### **Environmental information**

This Bang & Olufsen product was delivered in a packing made to protect and transport the product safely from the factory to your home.

In the design of our packing we use the most conserving and recyclable materials known to-day, and we constantly aim to reduce any negative side effects our packing materials may have on the environment.

We observe progress within the area of environmental protection with great interest.

*Corrugated cardboard* Made of at least 45 % recycled material. The printing ink contains no heavy metals, and the box is reusable for paper production.

*Foamed plastic parts* Made without use of injurious inert gasses. Can be recycled or incinerated, liberating carbon dioxide and water. Usable for soil improvement in granular form.

*Plastic bags* All plastic parts are free of PVC and can be recycled or incinerated, liberating carbon dioxide and water.

*Batteries* We urge you to show consideration when changing the batteries in your remote control terminal. Used-up batteries should be disposed of and kept separately.



