

BANG & OLUFSEN

B E O S O U N D O U V E R T U R E

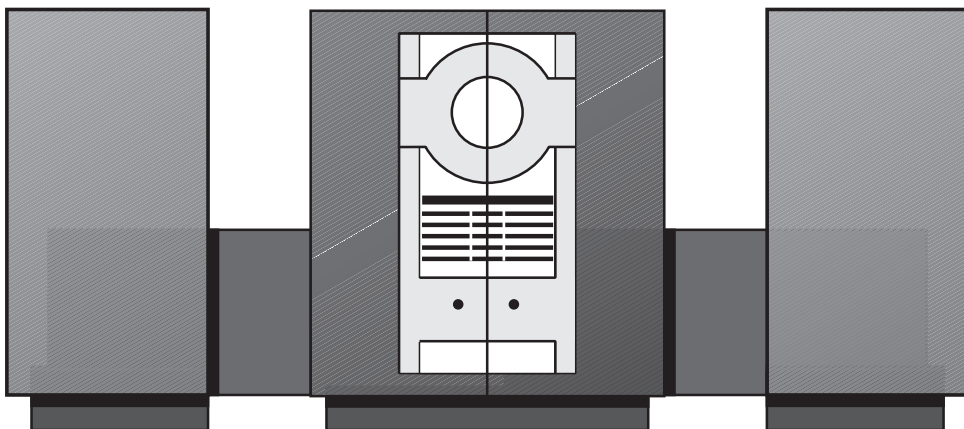

This Setting-up guide explains how to assemble your BeoSound Overture and make it ready for use. It describes how to set up the system with a pair of matching Beolab 2500 speakers or, as an alternative, with a pair of active Bang & Olufsen loudspeakers. The BeoSound Overture may also be used in a fully integrated Bang & Olufsen AV system (see the section "Ready for use...").

We recommend that you follow the instructions in this guide carefully. Please refer to the BeoSound Overture User's guide (also enclosed) for detailed operating instructions.

Contents

- 4 Before you start...
- 5 Placement
- 6 Connections
- 9 Assembling
- 10 Ready for use...
- 12 Maintenance

finished the setting-up procedure!

NOTE: Do not connect the BeoSound Overture to the mains before you have

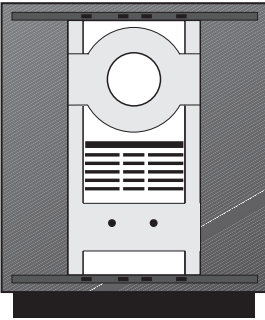

Make sure that the following parts are available before you start setting up the BeoSound Overture:

- one set of glass doors (left and right).
- one cable cover, for concealing and holding the cables on the rear of the BeoSound Overture.
- one lead for connection to the mains.
- a pair of active Bang & Olufsen speakers with connectors.

- 1 Place the BeoSound Overture where you want to use it.
- 2 Set up your speakers and any auxiliary equipment.
- 3 Connect all cables to their sockets on the rear panel of the BeoSound Overture (only, remember not to connect the system to the mains yet!).
- 4 Arrange the cables in the cable cover grooves, and attach the cover to the rear of the BeoSound Overture.
- 5 Attach the glass doors.
- 6 Connect the system to the mains.

When you set up your system, we suggest you use the following sequence:

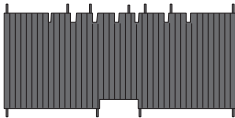
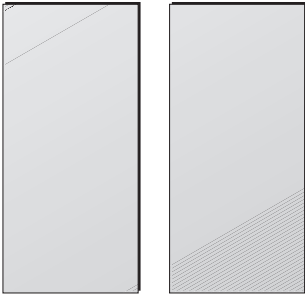

Complete the setting-up procedure as described in the section *Ready for use...* and make your presettings of sound levels, favourite radio stations, etc. as described in the BeoSound Overture User's guide.



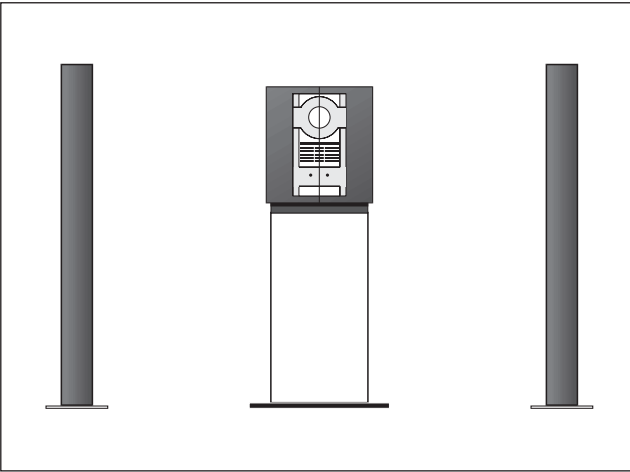

The BeoSound Overture is placed on the optional stand (with an alternative pair of active loudspeakers). The stand accommodates compact discs and tape cassettes.

Your BeoSound Overture is designed for a variety of placements. Its compactness facilitates placement next to your favourite listening position, which is also optimal for close-up operation of the system. It can be placed on a special stand, on a shelf or a table – or hanging off the wall (using the optional wall bracket). Please contact your Bang & Olufsen dealer for further information about optional accessories.

The BeoSound Overture is designed for use in dry environments only. Avoid placing the system in direct sunlight, near radiators or other sources of heat. Place the BeoSound Overture so that ventilation will not be impeded – and, in case you set up your system with alternative active speakers, remember to leave enough space at the sides of the BeoSound Overture for the glass doors to open and close.

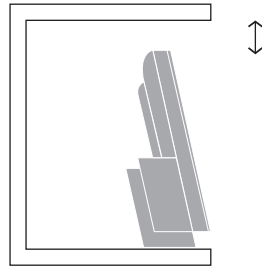

The slim cabinet allow placement in confined places. However, don't forget to leave enough space above and to the sides of the BeoSound Overture to provide sufficient ventilation.

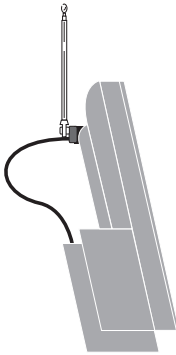

If no permanent FM aerial connection is available, an indoor aerial may be hooked on to the clamp on the back of the BeoSound Overture. When using an AM loop aerial, tune in to the radio station you want and then turn the aerial horizontally until optimum signal is received.

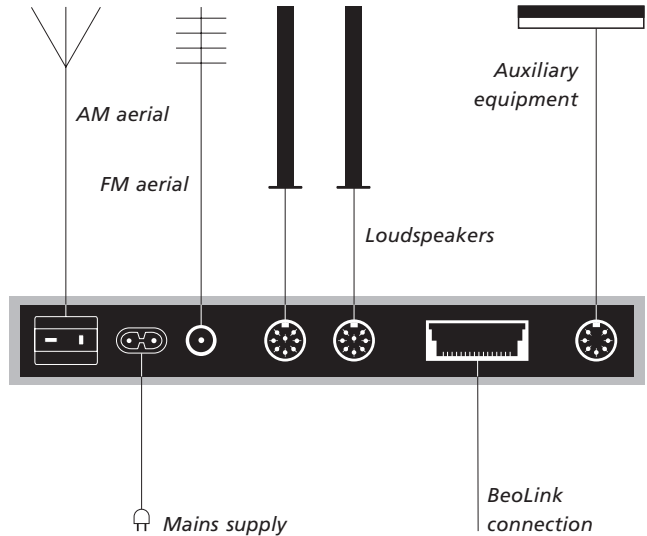

The socket panel on the rear of the BeoSound Overture is equipped with the following sockets:

- Two sockets for aerial connections.
- One socket for mains supply.
- Two sockets for the connection of active loudspeakers.
- One socket for BeoLink connections.
- One socket for the connection of auxiliary equipment.

Aerial

Connect your FM aerial to the socket marked FM and your AM aerial to the socket marked AM.

Loudspeakers

Connect your active Bang & Olufsen loudspeakers to the sockets marked POWER LINK. If you use a pair of alternative

active speakers, arrange the connector cables in the cable cover as shown on the next page (if BeoLab 2500 speakers, please refer to page 8 for further info).

Remember to set the L • R • LINE switch on your active speakers to L and R (left and right channel), respectively.

Auxiliary equipment

Connect your auxiliary equipment to the socket marked AUX.

This socket enables you to use compatible Bang & Olufsen equipment, e.g. a second tape recorder or a record player (with built-in preamplifier). The socket may also accommodate equipment of other makes. Consult your Bang & Olufsen dealer for details.

BeoLink connection

The socket marked MASTER LINK should be used when you interconnect your BeoSound Overture and a compatible Bang & Olufsen video system. Using a BeoLink cable, connect one plug to the socket on the BeoSound Overture and the other end to the corresponding socket on the BeoVision TV.

The socket may also be used for BeoLink distribution. The BeoLink system enables you to set up extra speakers throughout your house, and there listen to the BeoSound Overture in any room you like (please contact your Bang & Olufsen dealer).

Mains supply

Plug the mains lead into the socket marked ~, but do not switch on at the mains outlet yet.

Fasten the cable cover to the grill on the BeoSound Overture rear panel:

- a Insert the bottom row of pegs into the grill.*
- b Push the top row of pegs into the grill.*
- c Pull the cable cover upwards until the pegs mesh properly with the grill.*

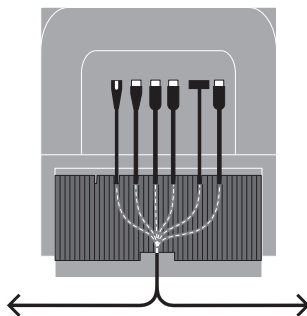
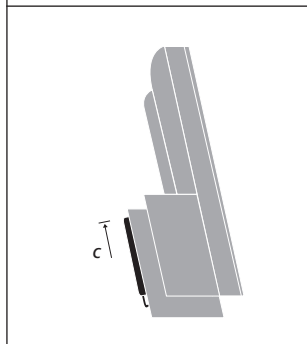
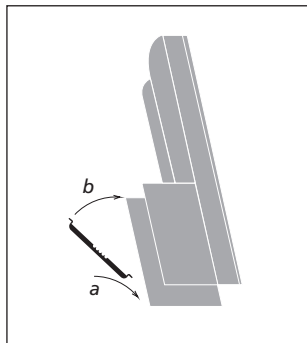

BeoLab 2500 loudspeakers

This page shows how to connect a pair of matching BeoLab 2500 speakers to your BeoSound Overture:

- Arrange all the connectors in the cable cover as shown.
- Fasten the cover to the grill on the BeoSound Overture rear panel (see page 7).
- Connect all the cables to the appropriate sockets.

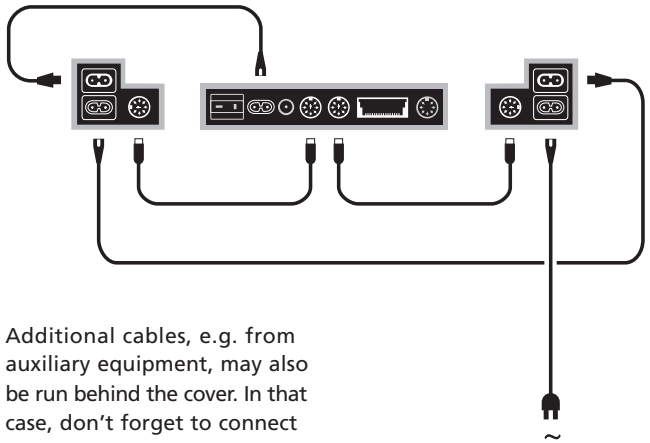
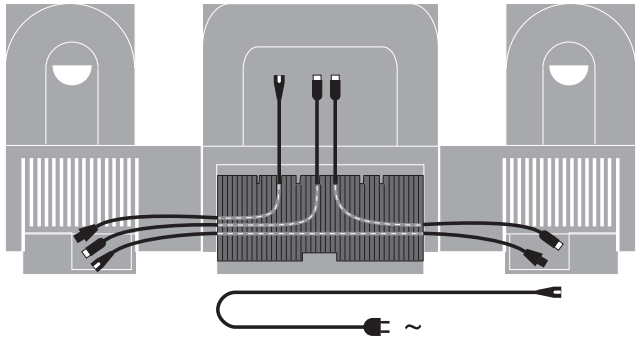

Additional cables, e.g. from auxiliary equipment, may also be run behind the cover. In that case, don't forget to connect the equipment to the BeoSound Overture before you fasten the cable cover to the rear grill.

Glass doors

The label on the back of each door indicates which end must point upwards, and which side must point towards the centre of the BeoSound Overture. Fasten the glass doors, one at a time, to the front of the BeoSound Overture by pressing their fastening points into the corresponding fastening sockets on the unit. Press gently on each of the fastening points until you hear a 'click'. The click indicates that the door is now properly seated.

Treat the glass doors with great care! If they crack or chip, or if they are damaged in any other way, they must be replaced immediately as they could otherwise cause bodily harm. You can order replacement doors through your Bang & Olufsen dealer.

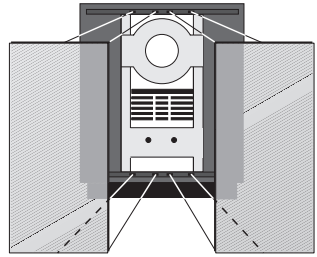

To complete the setting-up procedure, make your presettings of sound levels, favourite radio stations, etc. as described in the BeoSound Overture User's guide.

When you have finished setting up your BeoSound Overture (and any other equipment), connect it to the mains using the mains lead provided. A tiny red light appears in the display, indicating that the system is in stand-by mode and ready to be used.

However, in order for your setup to function properly, you may need to preprogram it to the correct *Option*. The BeoSound Overture can be programmed for the following setup situations (*Options*):

Option 0. Used in a fully integrated AV system with no speakers connected to the BeoSound Overture.

Option 1 (factory setting).

Used in a one-room setup, when the BeoSound is used either on its own, or in an AV integrated setup (with a pair of active speakers connected to the BeoSound Overture).

Option 2. Used in a two-room AV integrated setup.

Option 5: Used when the BeoSound Overture is placed in a link room which also comprises a Bang & Olufsen TV set.

Option 6. Used when the BeoSound Overture is placed in a link room *without* a Bang & Olufsen TV set.

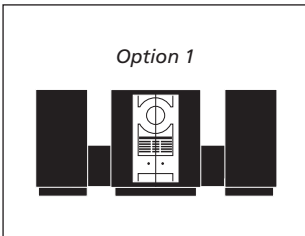

Using a Beo4:

- Hold the • button while pressing LIST. When the Beo4 display reads OPTION?, press GO.
- Press LIST once to display A.OPT and then key in the appropriate number (0, 1, 2 or 6).

Using a Beolink 1000:

- Press SOUND, the appropriate number (0, 1, 2 or 6), and then STORE.

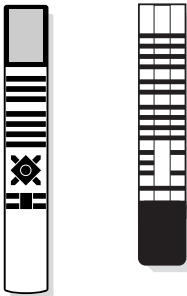

The preprogramming is done with a Bang & Olufsen remote control, and must be carried out with the system switched to stand-by.

The next page shows different setup situations. In all situations the BeoLink distribution of sound (and picture) to other rooms in the house is possible. For further information, please contact your Bang & Olufsen dealer.

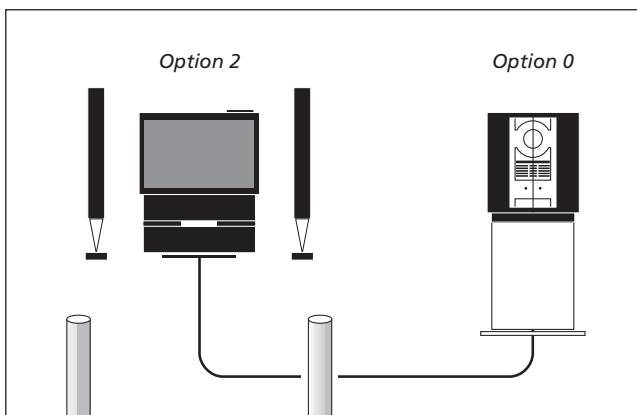

In a fully integrated Bang & Olufsen AV system, your Beo-Sound Overture acts as a mere audio source. The sound is reproduced through the speakers in the BeoVision TV – or, as shown here, through a set of active speakers connected to the TV.

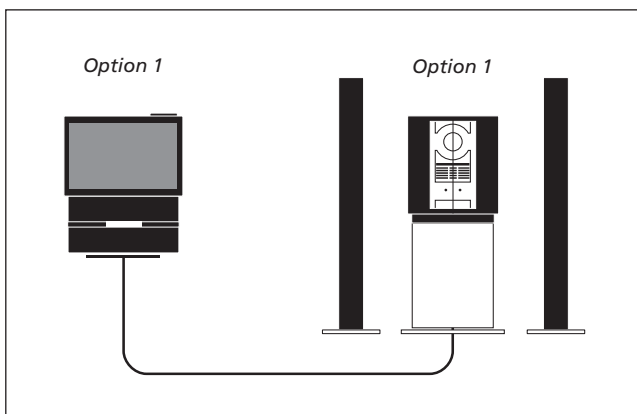

In a one-room AV integrated setup, a pair of active speakers has been connected to the Beo-Sound Overture (you can use either BeoLab 2500 or alternative Bang & Olufsen speakers).

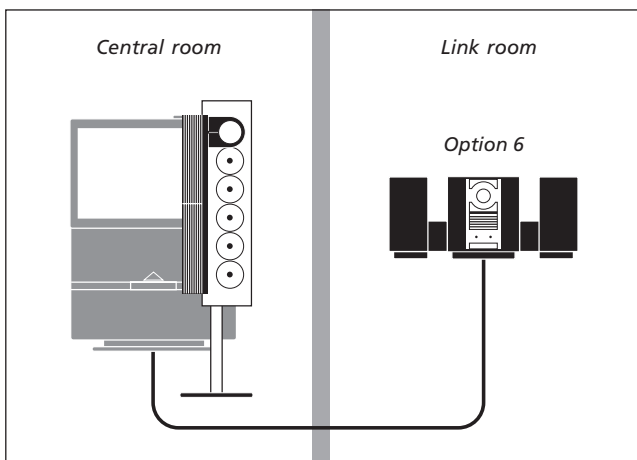

The BeoSound Overture set up in a link room. From the link room you have access to all the sources in the central room.

Use a soft, dry cloth to wipe dust off the BeoSound Overture.

Do not use alcohol or other solvents to clean any part of the BeoSound Overture!

Before you start cleaning the BeoSound Overture, we recommend that you disconnect it from the mains to prevent the glass doors from opening and closing automatically.

While the system is disconnected, you may open or close the glass doors manually, if you like. It requires only a little, gentle force to do so.

The glass doors can be removed and cleaned on the inside, if required. To remove the

glass doors, simply grip them tightly (one at a time – while they are open) and gently but firmly unhook them from their fastening points, pulling outwards. To clean the glass doors, we recommend that you use a mild window cleaner.

Fasten the doors again as described earlier in this guide. Leave the doors halfway open before reconnecting the BeoSound Overture to the mains.

Use a tape head maintenance kit or simply a cotton wool stick dipped in a rinsing fluid intended for this purpose. The cleaning process must be carried out while there is no cassette in the tape compartment:

- Press **A.TAPE**. The tape head and the right-hand pinch roller are now exposed, enabling you to clean them.
- Press **TURN**. The left-hand pinch roller is now exposed.
- Press **•** or switch to another source when you have finished the cleaning process.

Tape path

The tape path – that is, the tape heads, pinch rollers and other parts which the tape touches during playback or recording – should be

cleaned every now and then to avoid dust and fluff build-up. It is a good idea always to clean the tape path prior to making a recording.

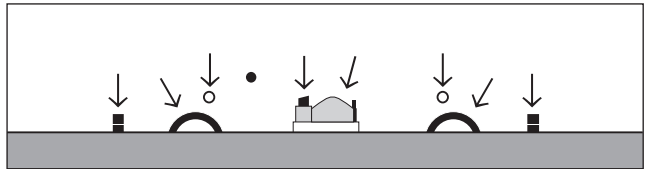

Environmental information

This Bang & Olufsen product was delivered in a packing made to protect and transport the product safely from the factory to your home.

In the design of our packing we use the most conserving and recyclable materials known today, and we constantly work to reduce any negative side effects our packing materials may have on the environment. We observe any progress with great interest.

Corrugated cardboard Made of at least 45 % recycled material. The printing ink contains no heavy metals, and the box is reusable for paper production.

Foamed plastic parts Made without use of injurious inert gasses. Can be recycled or incinerated, liberating carbon dioxide and water. Usable for soil improvement in granular form.

Plastic bags All plastic parts are free of PVC and can be recycled or incinerated, liberating carbon dioxide and water.

Batteries We urge you to show consideration when changing the batteries in your remote control terminal. Used-up batteries should be disposed of and kept separately.

The black and yellow label on the compact disc player serves as a warning that the apparatus contains a laser system and is classified as a class 1 laser product. In case of any trouble with the compact disc player, please contact your Bang & Olufsen dealer. The apparatus must be opened by a qualified serviceman only.

CAUTION: The use of any controls, adjustments or procedures other than those specified herein may result in hazardous radiation exposure.

—

This product fulfils the conditions stated in the EEU directives 89/336 and 73/23.



CLASS 1
LASER PRODUCT



COMPACT
disc
DIGITAL AUDIO



CE

3505632 0993

Printed in Denmark by
Bogtrykkergården a-s, Struer